

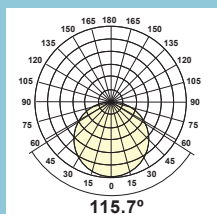

Beam angle

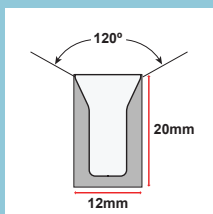

Dimensions



Neon FlexLED V4

4th Generation FlexLED Neon

Neon FlexLED V4 LED lighting is the perfect replacement for traditional neon lighting. Not only is it easily customizable but it is far more durable than traditional neon. Our V4 neon is slightly larger than our V3 neon at 12MM (0.47") in width and includes solderless IP67-rated connections. It also is available in a horizontal bend or as a vertical bend. 6 different LED versions with endless possibilities for colour and control. RGB, RGBW (2700k or 5600k), colour temperature adjustable 2700k - 5500k, and RGBW pixel control (2700k or 5600k). All versions have the ability to dim from 0 to 100% and can be controlled via any of our constant voltage controllers. (DMX / Rotary Knob Control / Zigbee). The RGBW Pixel control LED can be controlled via any of our pixel controllers.

This product is widely used as a replacement for traditional neon but also as a way to illuminate and decorate locations such as film and television sets, concert touring, restaurants, theatrical spaces, exhibition halls, bars, shopping malls, theme parks, casinos and much more.

Standard NeonFlex V4 has a flat top for viewing at 120 degrees.

IP67 rated makes this the perfect product for indoor or outdoor use. cULus rated, as well as RoHS, and CE compliant making it safe for use anywhere in the world.

Factory lengths of 10 meters (32.81 feet) but customizable every 5 to 10CM (depending on LED type) making it the perfect product for many uses. Utilizing our standard high CRI white LEDs make for beautiful soft white output as well as creating beautiful pastel colours when mixed with the colour LED options.

95+ CRI	24V DC	120° BEAM ANGLE	5 years	Dimmable	10M (32.8')	CUSTOMIZED LENGTHS	White
cULus LISTED E489028	RoHS	CE	Width 12MM	IP67 OUTDOOR	RGB+W	RGB	CCT Adjustable

TECHNICAL SPECIFICATIONS

NO:

Neon FlexLED V4

1	PRODUCT TYPE	White	RGB+W	RGB	Bi-Colour	RGB+W Pixel UCS7604
2	PRODUCT CODE	NF-W24VF1220-XX00-95-10MBEW	NF-W24VF1220-RGBWXX-95-10MBEW	NF-W24VF1220-RGB-50-10MBEW	NF-W24VF1220-BC2750-95-10MBEW	NF-W24VF1220-RGBWXX-95-UCS7604-10MBEW
3	CRI / TLCI	95+		N / A	95+	
4	COLOUR TEMP. OR WAVELENGTH	2100K / 2400K / 2700K / 3000K / 3500K / 4000K / 5000K / 6000K	Colour Changing R/G/B/W 2700K or 5600K	Colour Changing RGB	2700K ~ 5000K or 2700K ~ 5500K	Colour Changing R/G/B/W 2700K or 5600K
5	WAVELENGTH	WHITE				
6	CURRENT, RATING	0.79 A / METER				
7	VOLTAGE	24 VDC				
8	WATTAGE	15W / METER				
9	CC / CV	CONSTANT VOLTAGE				
10	IP RATING	IP67				
11	LUMENS @ FULL	360 ~ 465 lm / METER	600 ~ 800 lm / meter			
12	LUMEN / WATT	24 ~ 31 lm / METER	N/A			
13	LIFETIME*	30,000 HOURS				
14	CUTTING LENGTH	5 CM				8.33 CM
15	LEDS/METER QUANTITY	120 LED / METER	96 LED / METER	280 LED / METER	84 LED / METER	
16	LED TYPE	2835	5060	3838	2016	5060
17	NUMBER OF CONTACTS	2	5	4	3	4
18	COPPER QUANTITY	3 Oz.				
19	OPERATING TEMPERATURE RANGE	-40° TO - 60° C				
20	AGENCY RATINGS	UL E489028, CE, RoHS				
21	DIMENSIONS TOP / BASE	12 X 20 MM				
22	MAXIMUM RECOMMENDED LENGTH	10 METERS (Power injection at both ends recommended)				
23	VIEWING ANGLE	120 DEGREE				
24	ADHESION/ADHESION	3M VHB5952 Adhesive Mounting Clips Sold Separately				
25	PIXEL PROTOCOL	NONE				UCS7604

Neon FlexLED SKU ORDERING CODES

NF	W	24	V	F1220	RGBW27	95	UCS8904	5M	BEW
1	1	1	1	1	1	1	1	1	1
Series	IP Rating (IP67)	Operating Voltage	Voltage	Shape & Dimensions	Colour & CCT	CRI	Pixel Protocol	Length	Connector

1 Family Series NF NeonFlex	2 IP Rating W IP67 - Weatherproof	3 Voltage 24V 24VDC (Standard) 5-36V Custom Order	4 Voltage Type V Constant Voltage (Standard) C Constant Current (Optional)	5 Shape & Dimensions F1220 Flat 12MM X 20MM
6 Colour & CCT XX00 White -2100 ~ 6000k RGB Red + Green + Blue RGBW27 Red + Green + Blue + 2700k RGBW56 Red + Green + Blue + 5600k BC2750 2700K + 5000K	7 CRI 95 95 (Standard) 80 80 Optional	8 Pixel Protocols UCS7604 UCS7604 Standard Various pixel protocols available Contact us for more information	9 Length 10M 10 Meters (Standard) 0.5CM -> 10M (Optional)	10 Connector BEW Bare End Wire (Standard) SPM SPM Chogori Connector XXX Optional - Contact Us

TECHNICAL SPECIFICATIONS

CONNECTORS



Front cable Connector



Side cable Connector



Bottom cable Connector

MOUNTING ACCESSORIES



Stainless steel clips
20x12.7x18.7mm



Aluminium profile
1000x14.4x21.4mm



Flexible profile



Suspension wire



END CAPS



The bottom of the LED strip has a transparent window. The black marker is the cutting point.

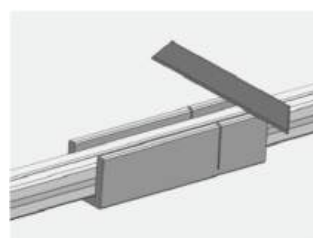

Use a cutting jig or straight-edge, precisely cut on the line in order to ensure no damage to the LED.

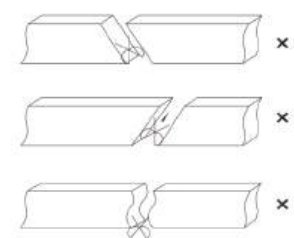

When cutting the neon, do not cut on an angle as it will not properly mate with the end caps or connectors.

ASSEMBLY INSTRUCTIONS - WITH CONNECTOR

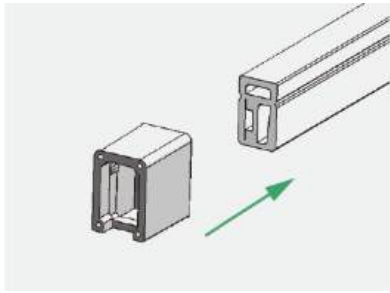

Insert the shell into the strip as far as possible

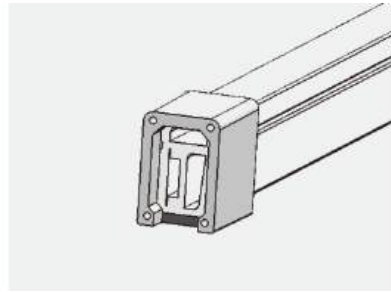

Ensure the opening is at the bottom of the strip

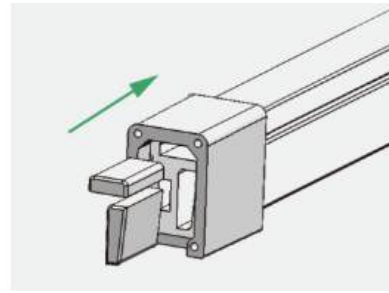

Insert the plug into the holes of the LED Neon

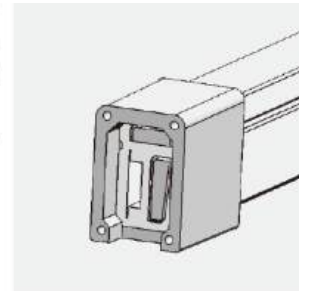

Ensure the plug is inset further than the outer shell.

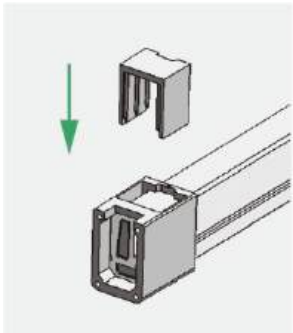

Insert the stopper into the shell.

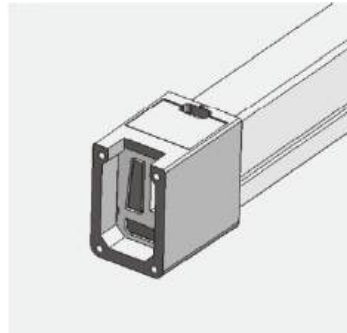

Ensure the stopper is fully inserted

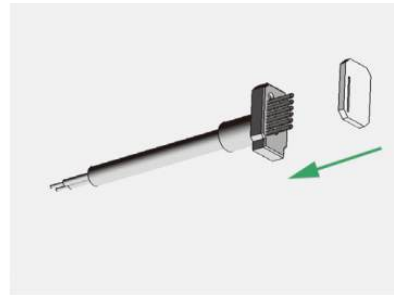

Put the waterproof washer into the plug

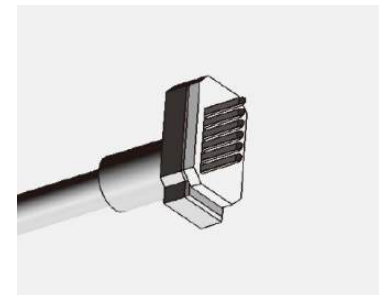

Ensure the washer is pushed to the back

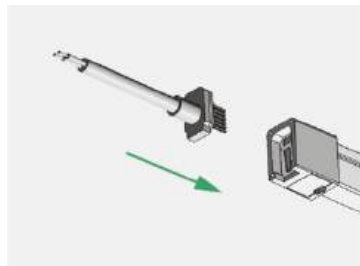

Insert the plug into the led strip and ensure the pins make contact with the LED strip

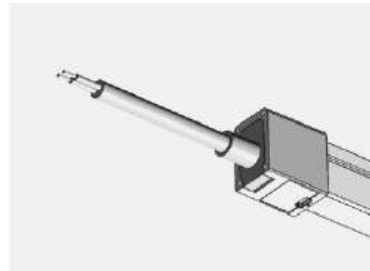

Assembly should be fully inserted.

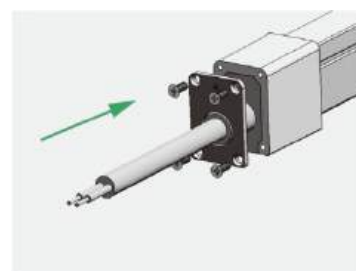

Screw the end cap onto the shell with the provided screws.

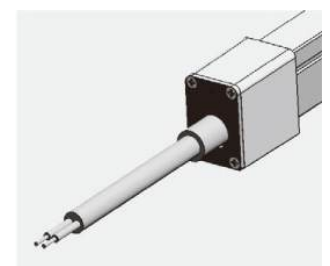

Completed assembly.

ASSEMBLY INSTRUCTIONS - END CAP

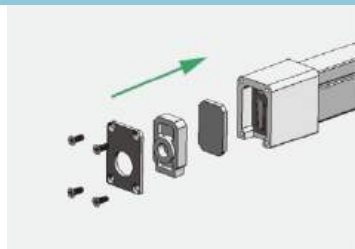

End cap's installation diagram

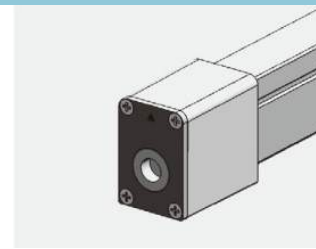

Effect diagram of the metal plate assembly completed